

ULTIMAT GOLD

Produced by The Creative Workshop, all rights reserved. All information contained in this leaflet, or parts thereof, may not be reproduced in any form without permission of KEENCUT LIMITED.

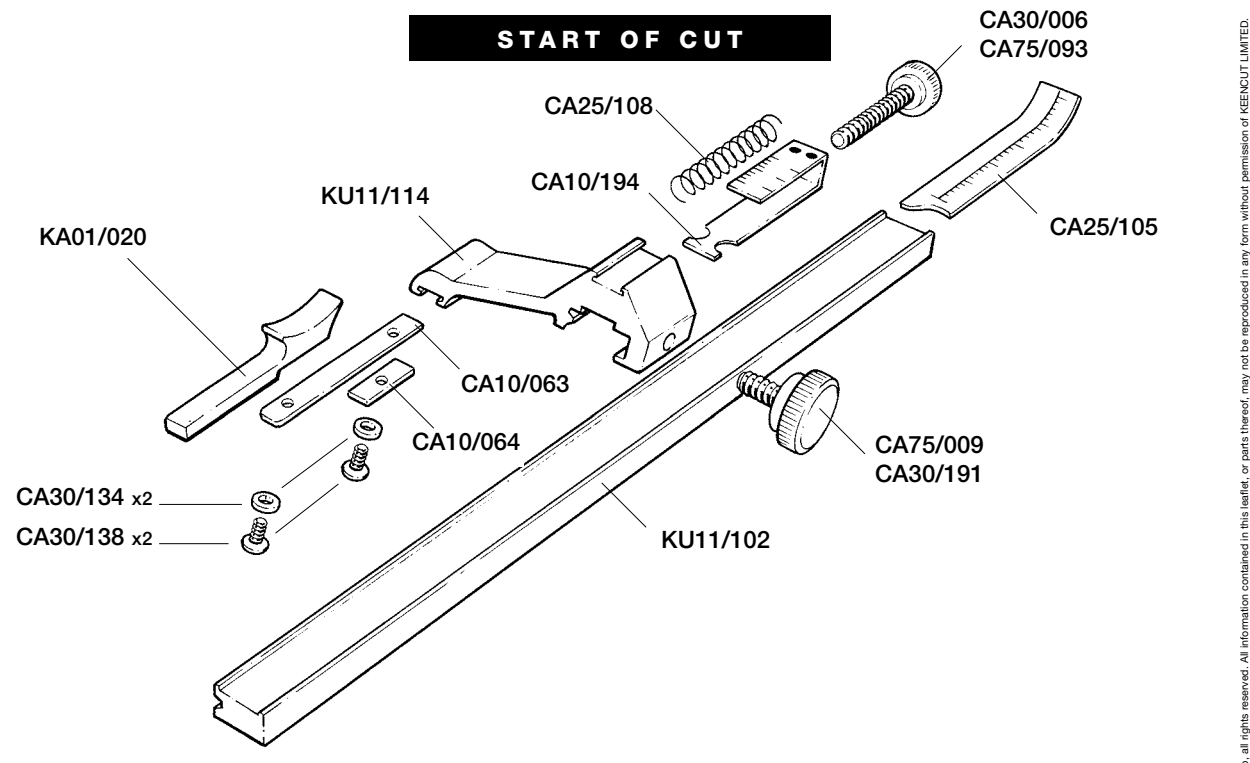

CUTTER HEAD

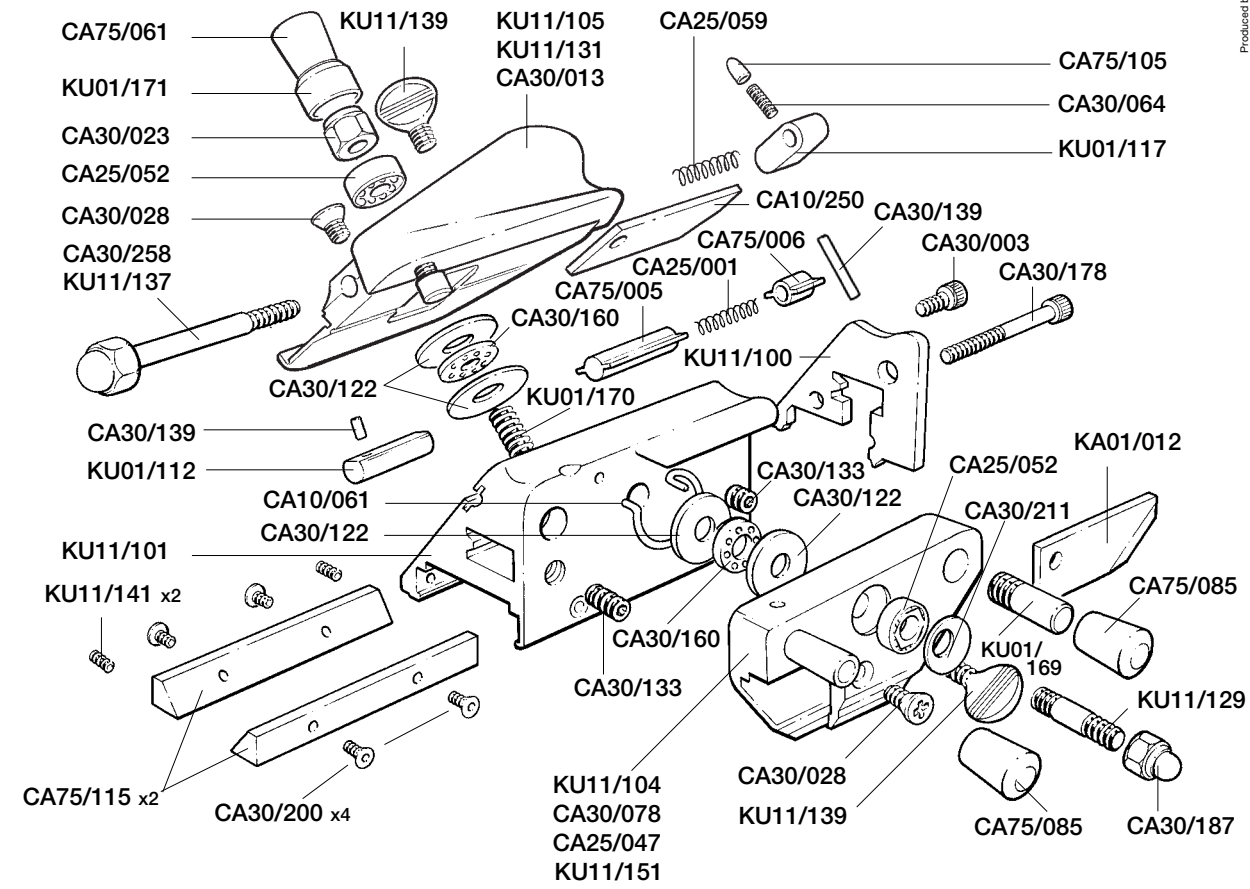

KEENCUT ULTIMAT GOLD

SPARE PART REFERENCE

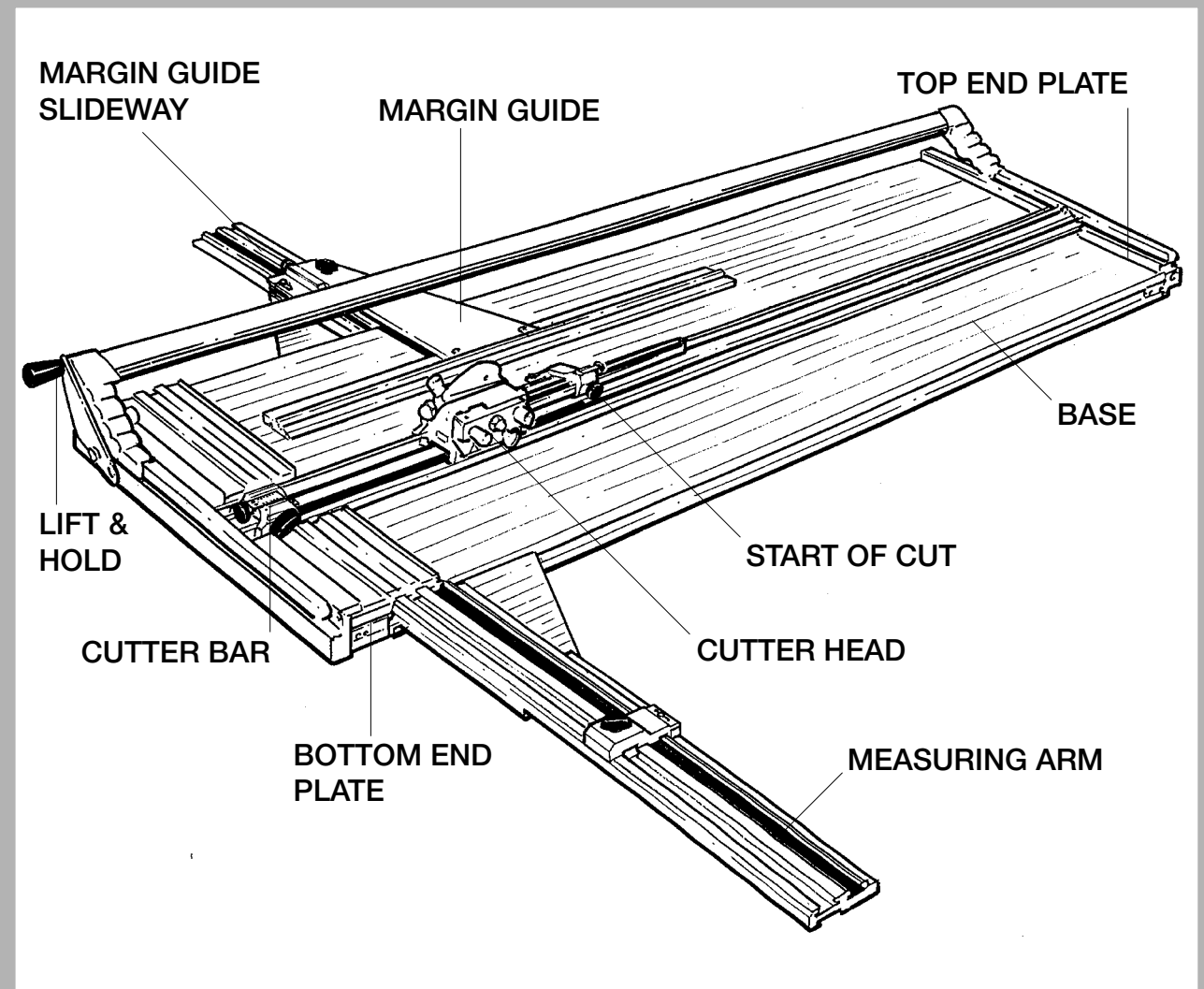

KEENCUT THE WORLD'S FINEST CUTTING MACHINES

KEENCUT LIMITED,
 Baird Road, Willowbrook Industrial Estate, Corby,
 Northamptonshire, ENGLAND NN17 5ZA.
 TELEPHONE: 01536 263158 FAX: 01536 204227

KEENCUT INC. (North American Sales)
 3560 Pine Grove Ave.#366 Port Huron, Michigan, 48060 USA.
 Toll Free: 1 800 240 KEEN(5336)
 TELEPHONE: 1(519) 652 0970 FAX: 1(519) 652 0396

JULY 2008

KEENCUT THE WORLD'S FINEST CUTTING MACHINES

KEENCUT ULTIMAT GOLD

N.B. Fixings blocks for Top End Plate are of type **KU01/132** and not **KU01/153**.

MARGIN SLIDEWAY

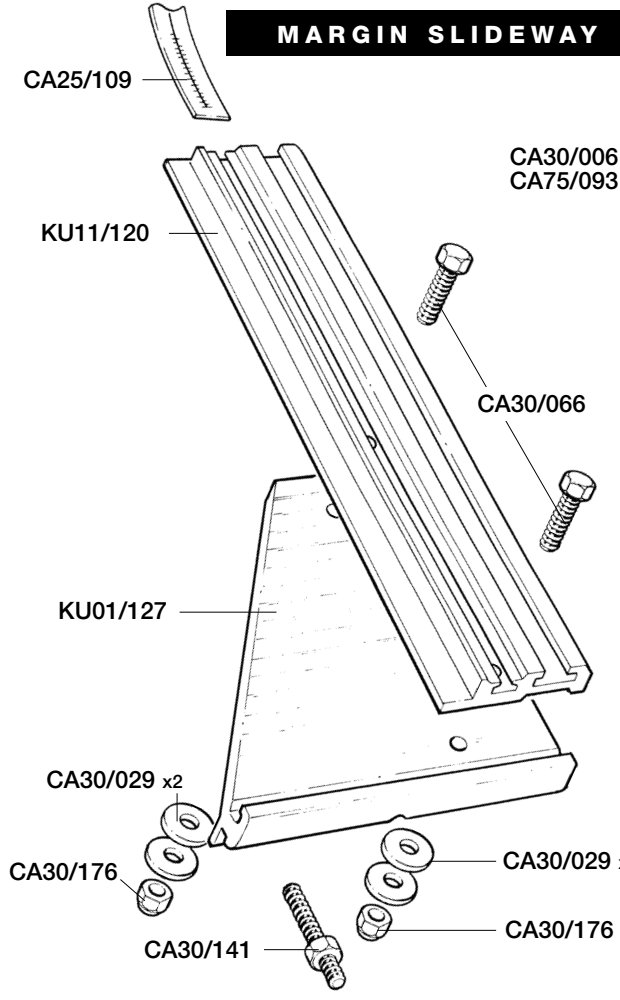

MARGIN GUIDE

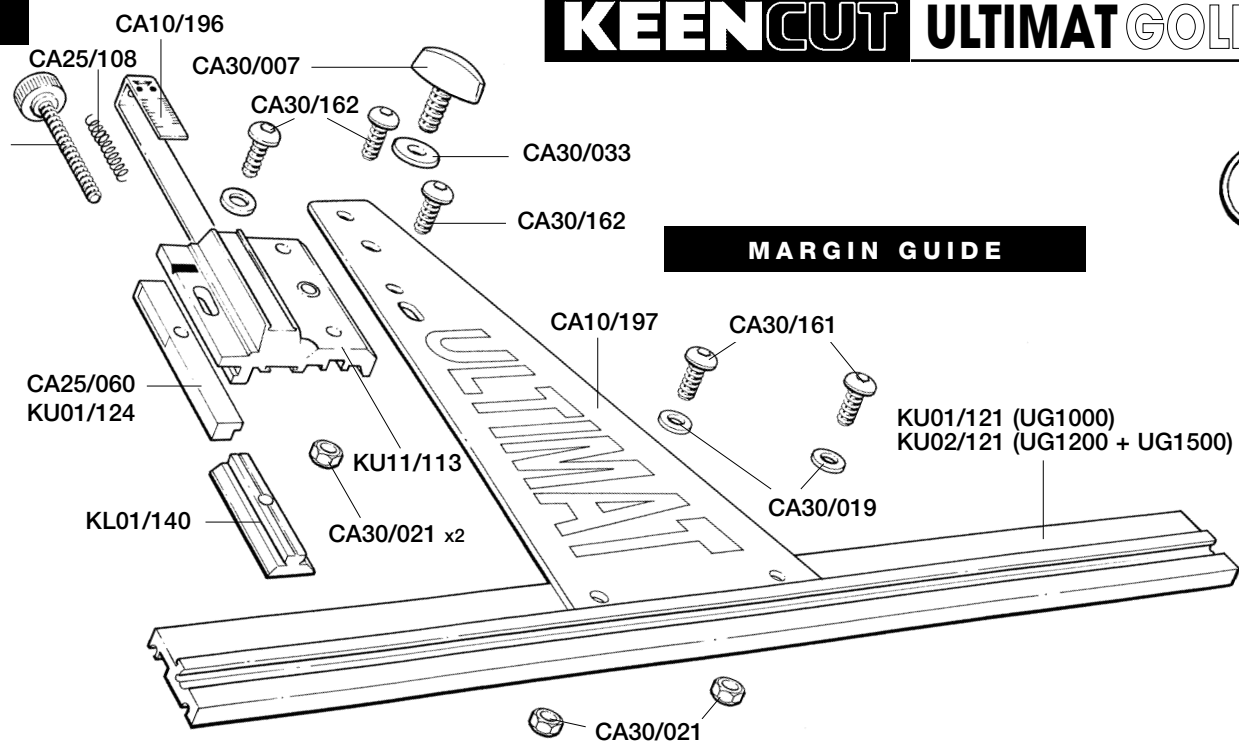

TOP END PLATE

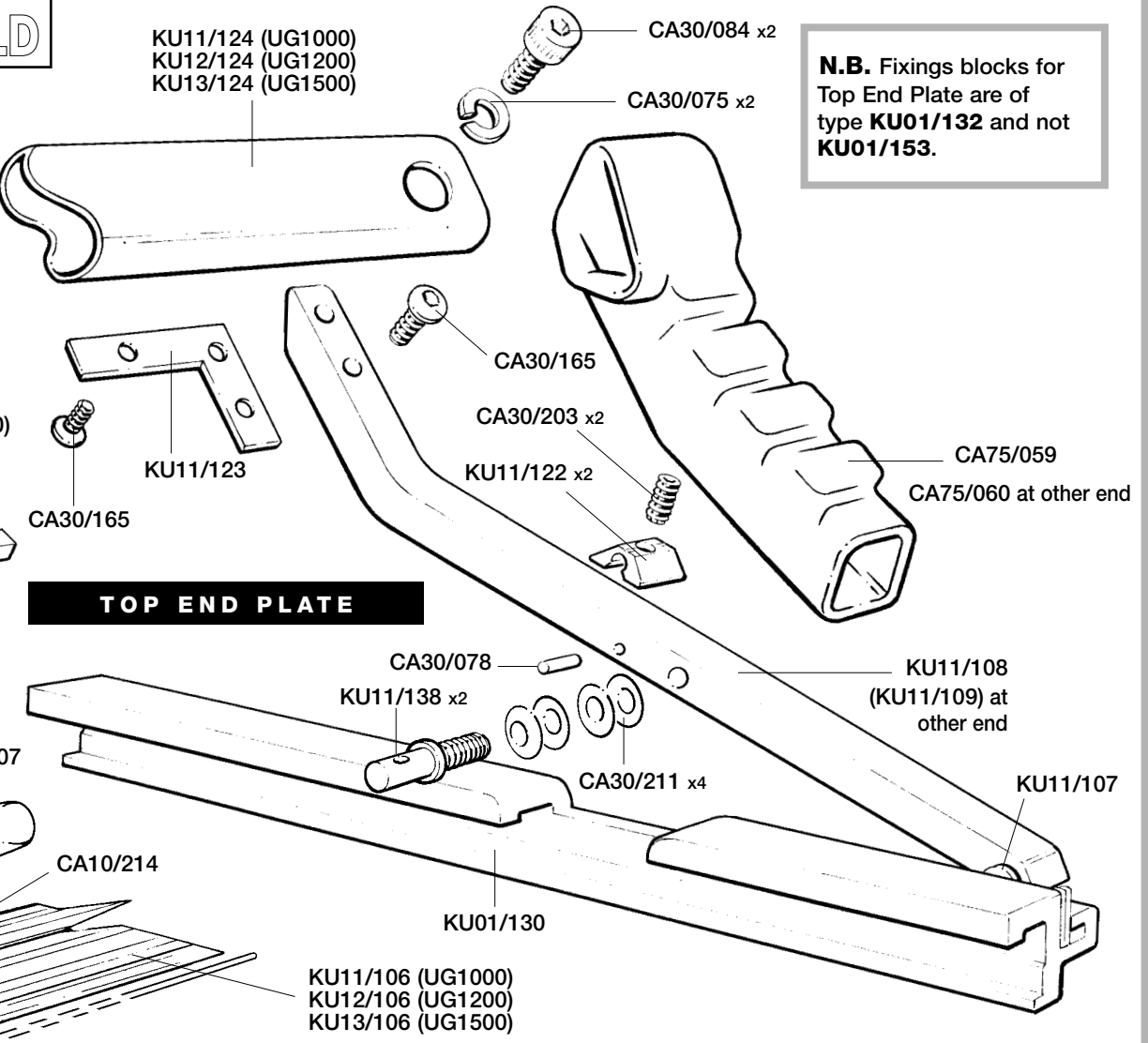

CUTTER BAR

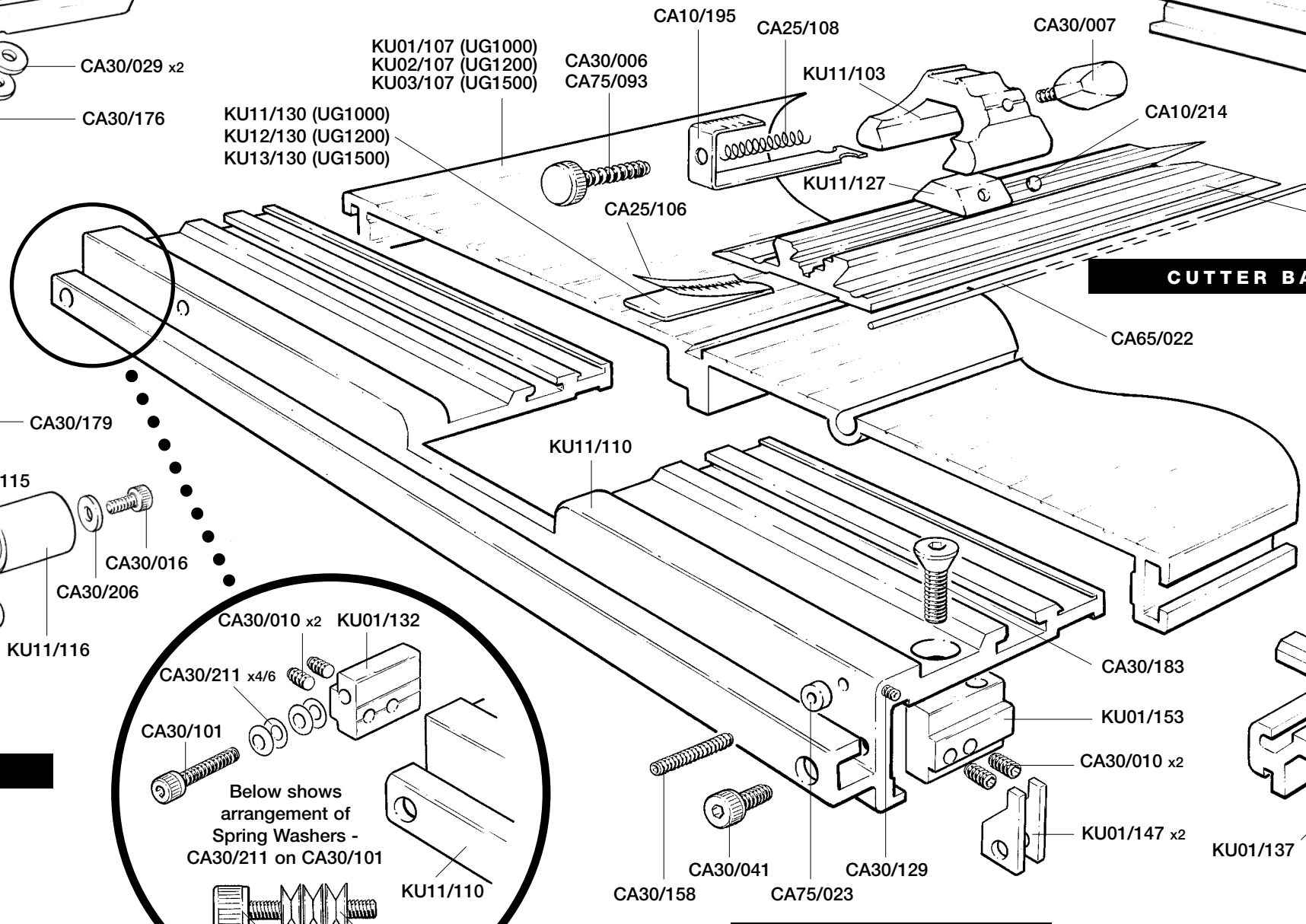

BOTTOM END PLATE

MEASURING ARM

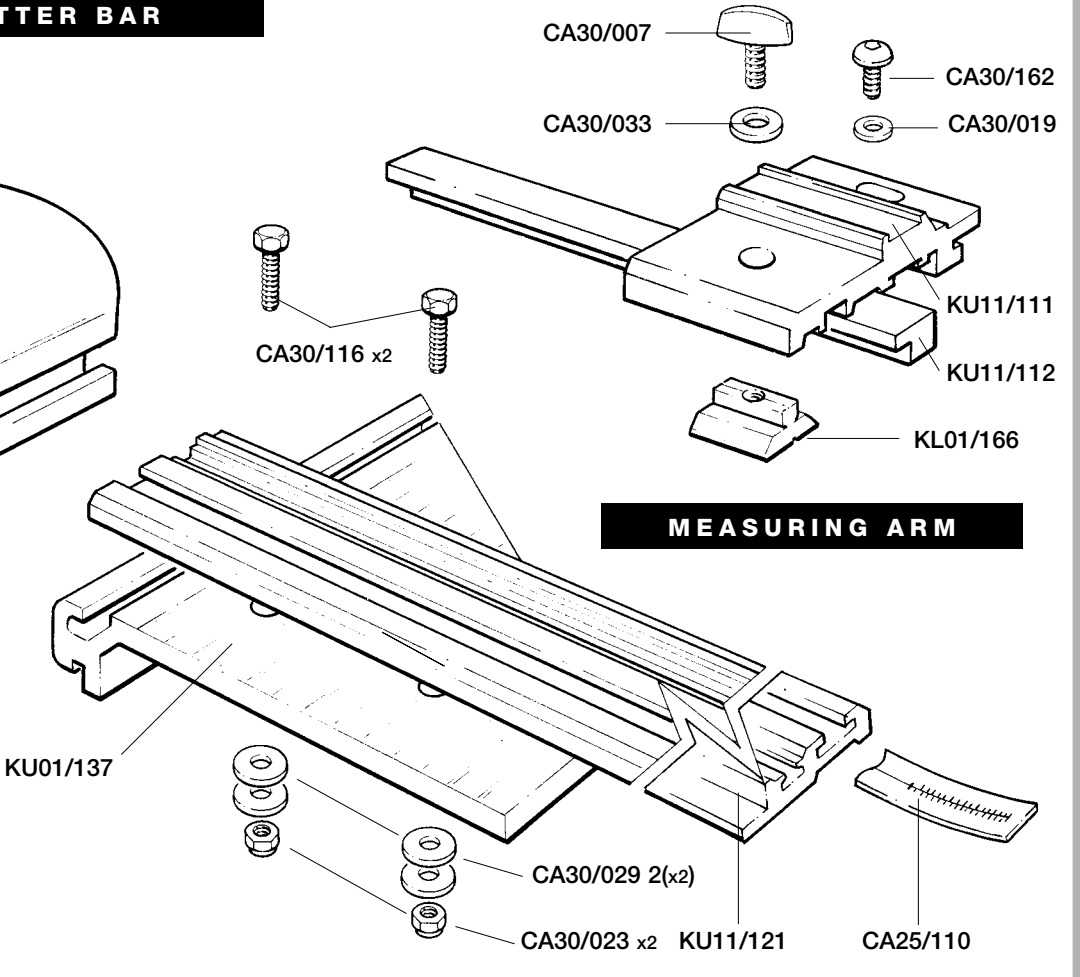

LIFT & HOLD

